

# Avery Weigh-Tronix

## SensorComm™

### Digital J-Box System

SensorComm is the Avery Weigh-Tronix microprocessor-based digital J-Box. It gives unparalleled flexibility to new and existing truck scale and batching Weigh Bar® systems.



## Digital J-Box System

SensorComm is the Avery Weigh-Tronix microprocessor-based digital J-Box. It gives unparalleled flexibility to new and existing truck scale and batching Weigh Bar® systems.

Designed to meet the rigors of all weather environments, SensorComm converts analog weight sensor signals to digital output. Once the data has been converted to digital output it is transmitted to the Avery Weigh-Tronix Model 1310 Programmable Indicator by serial cable or the optional fiber optic link. The fiber optic link allows an extra measure of isolation from lightning strikes prevalent in many areas of the country.

## Features & Benefits:

- Quick system calibration
- Environmentally rated NEMA 4X enclosure
- Rapid corner balancing
- Interface cable performance verification
- Signal strength monitoring
- Deadload shift analysis
- Individual weight sensor monitoring
- Operator "system warnings"
- Hardwire interface distance to 400 feet
- Fiber optic interface distance to 1000 feet
- Each SensorComm assembly accommodates four weight sensors
- Input and excitation voltage monitored
- Audit counts in "real time"

## Specifications:

### Environmental

**NTEP tested temperature** – 14°F to 104°F (-10°C to 40°C)

**Operating temperature** – -40°F to 140°F (-40°C to 60°C)

**Humidity** – 0-90% relative, non-condensing

**Enclosure** – Type 304 Stainless steel, NEMA 4X rating

**Suppression** – EMI and lightning

### Mechanical

**Dimensions** – 10" L x 10" W x 2.125" H  
(25.4 cm x 25.4 cm x 64.8 cm)

**Weight** – 5.7 lb (2.6 kg)

**Cable fittings** – Waterproof with relief

**Cable termination** – Spring tensioned

### Electrical

**Power requirements** – 12-15 vdc @ .625 amps supplied by 1310 indicator (Fiber optic interface option requires power from additional source)

**Agencies** – Complies with FCC part 15

### Performance

**Inputs** – Four 1 to 5mV/V analog sensor inputs

**A/D conversion** – Sixty times/second for each input

**Weight sensor excitation** – 10 vdc

**Resolution per channel** – Exceeds 1,000,000 counts

**Data transfer rate** – 20 Hz

**Data output** – proprietary data stream

**Digital filtering** – Harmonizer™

**Agencies** – #02-018 Legal for Trade Certificate of Conformance

**Patents** – U.S. Patent Numbers 5,750,937 and 6,552,278

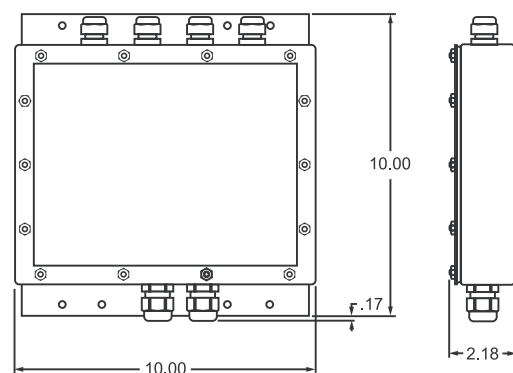

## AUTHORIZED DISTRIBUTORS

### Ask the experts.

Weigh-Tronix distributors are complete support centers, providing needs assessment, technical information, product sales and service. Their experience is a valuable resource that is readily available to you. We recommend you consult these knowledgeable industrial applications specialists for all of your weight measurement needs.

Please call us or visit  
[www.wtxweb.com](http://www.wtxweb.com)  
for your nearest  
Weigh-Tronix distributor.

## Avery Weigh-Tronix

Fairmont, Minnesota U.S.A.  
USA Toll-Free: 800-368-2039  
USA Phone: 507-238-4461  
[www.wtxweb.com](http://www.wtxweb.com)

Pointe Claire, Quebec Canada  
CAN Toll-Free: 800-561-9461  
CAN Phone: 514-695-0380  
[www.weigh-tronix.ca](http://www.weigh-tronix.ca)

